

# G50 & G50 Air

A flip front welding and grinding helmet



G50 is a combined welding and grinding helmet and houses an ADF Automatic Darkening Filter, shade levels DIN 9-13, and with flip-up visor. The large plastic lens gives the welder an unobstructed field of view when the visor is flipped up. The helmets are rated B in the impact resistance classification, which means they are approved for grinding.

- Lightweight shell
- Automatic / fix shade options
- Large inner grinding visor (clear)
- Comfort headgear
- Respiratory option with ESAB PAPR

Visit [esab.com](http://esab.com) for more information.

## Process

- SMAW/MMA (Stick)
- GMAW (MIG/MAG)
- GTAW (TIG)
- Grinding
- Oxy Fuel Cutting
- Plasma Cutting
- PAW - Plasma Arc Welding



*G50 Air with ESAB PAPR*

## Specifications

Model	G50
Viewing Area	97 x 47 mm
Lens Shade	9-13 Automatic
Power Supply	Solar cell, no battery change
Standards	EN12941 Class TH3 P R SL
Classification	1/1/1/2
Weight Standard Helmet	730 g
Weight Air Version Helmet	890 g

## Ordering Information

G50 9-13 *	0700000438
G50 Air 9-13 Prepared for fresh air (incl. air duct and face seal) *	0700000441
EPR-X1 PAPR system with expandable hose	0700500900

## Wear and Spare Parts

1. Main Shell G30, G40 & G50	0700000515
2. Large inner Visor G30, G40 & G50 - Clear	0700000501
3. Front Cover Lens G40 & G50	0700000517
4. Filter Lens 60 x 110 Shade 10 Pk 25	0160292002
4. Filter Lens 90 x 110 Shade 10 Pk 25	0760031632
5. Lens Retainer G40 & G50	0700000518
6. G50 ADF	0700000523
7. Cradle G40 90 x 110 & G50	0700000519
7. Cradle G40 60 x 110	0700000520
8. Gasket for Mineral Glass G40 60 x 110 & 90 x 110	0700000521
9. Head gear	0700000415
9A. Sweat band	0700000414
10. Headgear including air duct	0700000420
11. Head & Face Seal for G30, G40 & G50	0700000512
Kit Bag (empty)	0700002315
G40/G50 Helmet Flip without ADF	0700002190
G40/G50 Front Flip Adjustment Knob Black	0700002191
G40/G50 Headgear Adjustment Knob Set Yellow	0700002192

\*Delivery includes: Full helmet assembly, 1 inner grinding lens, 2 outer cover lenses, 2 inner ADF cover lenses.  
For additional information on PAPR units please see separate fact sheet.

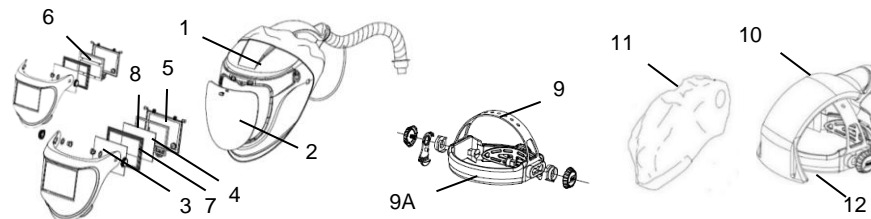

ESAB / esab.com

